

OUTDOOR LED SECURITY LIGHT

IMPORTANT SAFETY INFORMATION

This Outdoor LED Security Light cannot be used with dimmers or timers, and is to be used only on circuits controlled by a single switch.

This fixture is designed for outdoor use only. Fixture must be wall or eave-mounted onto a 4" round junction box. If junction box is surface-mounted and exposed, it must be approved for wet/outdoor locations.

WARNING

Use only with copper wire.

Install in accordance with all appropriate electrical codes and requirements.

SELECTABLE COLOUR TEMPERATURE

Located on the back of the fixture, choose your preferred colour of light by sliding the switch to one of **5** choices:

27K = Warm White **40K** = Cool White
30K = Bright White **50K** = Daylight
35K = Neutral White

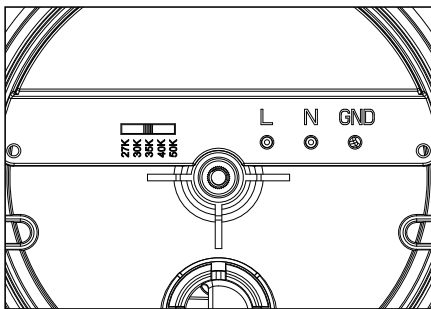

Note: At anytime, you can change the colour of light by removing fixture from junction box and sliding switch to a different light colour.

LOCATING THE DUSK-TO-DAWN/MOTION-SENSOR LIGHT

The light control is affected by brightness, temperature and moving objects.

Do NOT install near other sources of light, as this can affect the light sensor's detection.

When installing, ensure the sensor is not placed too close to trees.

Movement of branches in the wind may trigger the motion sensor.

The sensor cannot detect infrared light through glass.

The sensor is very sensitive to lateral motion, with a max. detection distance of 15m.

INSTALLATION INSTRUCTIONS

Before undertaking work on the circuit, disconnect power by switching circuit breaker to **OFF** or by removing fuse.

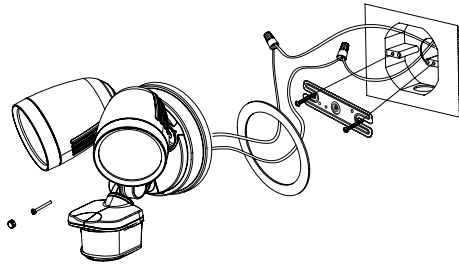

Recommended Installation Height:
1.98m (6½ ft.) to 3.05m (10 ft.)

- 1 Mount crossbar plate (**DD**) to the junction box using the 2 mounting screws provided (**FF**).
- 2 Connect the GREEN fixture ground wire to the Green or Bare copper ground wire or ground screw in junction box using the supplied wire connector (**EE**).
- 3 Connect the WHITE wire from the fixture to the WHITE wire from the junction box using the supplied wire connector (**EE**).
- 4 Connect the BLACK wire from the fixture to the BLACK wire from the junction box using the supplied wire connector (**EE**).
- 5 Carefully tuck all wires back into junction box.
- 6 Position the fixture with gasket (**CC**) provided over the crossbar plate (**DD**) and secure to centre hole of crossbar plate with stainless steel screw (**BB**) to hold fixture in place. Insert plastic screw cover (**AA**) into screw hole.
- 7 Turn circuit back on at breaker/fuse panel and make sure switch is in the ON position.

ADJUSTING YOUR LIGHT HEADS

Make sure the light control sensor is not upside down.

Light heads can be adjusted by turning the individual light head to desired position. You can also adjust light head up or down to your desired position.

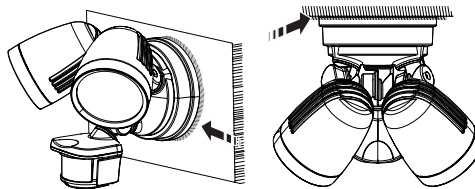

Note: Aim LED heads at least 20° down to prevent risk of water from accumulating inside the lens.

Decide whether you want your Outdoor LED Security Light to function as MOTION SENSOR or DUSK-TO-DAWN, then follow the appropriate instructions below.

CHOOSING & SETTING THE MOTION DETECTION MODE

OPTION A

With no motion detected at night, the light turns OFF. When motion is detected within the pre-set range, the light will turn ON at 100%.

Set **MODE** to "**OFF**".

Set **SENS** to adjust motion sensing distance.

MIN = 20% (3M) to **MAX** = 100% (15M).

Set **TIME** to how long lights turn off after motion stops.

Adjust the time anywhere between:

15 = 15 seconds (MINIMUM TIME).

20MIN = 20 minutes (MAXIMUM TIME).

OPTION B

With no motion detected at night, the light maintains 30% brightness.

When motion is detected within the pre-set range, the light will turn ON at 100%.

Set **MODE** to "**AUTO**".

Set **SENS** to adjust motion sensing distance.

MIN = 20% (3M) to **MAX** = 100% (15M).

Set **TIME** to how long lights turn off after motion stops.

TEST = 15 SECONDS (MINIMUM TIME).

20MIN = 20 MINUTES (MAXIMUM TIME).

OPTION C – SPECIAL APPLICATION

Light functions exactly like OPTION A (above), but light will stay ON for a 3 hour period of your choice.

MODE dial must be set to "3H" at the beginning of the desired 3 hour period.

Set **SENS** to adjust motion sensing distance.

MIN = 20% (3M) to **MAX** = 100% (15M).

Set **TIME** to how long lights turn off after motion stops.

TEST = 15 SECONDS (MINIMUM TIME).

20MIN = 20 MINUTES (MAXIMUM TIME).

After the 3 hour period, the light will return to Motion Detection mode.

The light will then function this way everyday.

CHOOSING & SETTING THE DUSK-TO-DAWN MODE

Dusk-to-dawn mode will automatically activate the lights once the ambient light (daylight) falls below a certain level (dusk).

The lights will stay on for the duration of the night and will automatically shut off at dawn (daylight).

Set **MODE** to "**PC**".

"**SENS**" and "**TIME**" dials – no setting required for this mode.

MANUAL OVERRIDE

To override the MOTION SENSOR function so that light is constantly "ON", quickly toggle switch OFF and then ON within 1-3 seconds.

To return to automatic MOTION SENSOR mode:

Turn switch OFF.

Wait 20 seconds.

Turn switch ON.

The light will go through a warm-up cycle before resetting back to motion sensor mode.

MOTION DETECTION TESTING

Allows the positioning of the light's motion sensor to be tested day or night.

Once the motion sensor is in the desired position, set the **TIME** dial to "**TEST**".

Attempt to trigger the light by moving in the intended detection zone.

If light turns on (for about 3 seconds), the motion sensor is positioned correctly.

CARE AND MAINTENANCE

To clean the surface of the fixture, use mild soap and water.

Do not use scouring pads, powders, steel wool or any other abrasive materials.

Do not immerse in water.

5 YEAR LIMITED WARRANTY

PowerSource warrants this product to be free from defects in material and workmanship for a period of 5 years from date of purchase. Warranty obligations are limited to replacing the product. Customer must provide a copy of the original proof of purchase. We are not responsible for any other loss or damage which may arise through use or installation of this product. Warranty is void if damage is due to misuse or abuse.